

GOODWE



User Manual

Rechargeable Li-ion Battery System

Lynx Home F Series G2

V1.1 -2023 -10-30

Trademarks

GOODWE and other GoodWe trademarks are trademarks of GoodWe Technologies Co.,Ltd. All other trademarks or registered trademarks mentioned in this manual are owned by the company.

NOTICE

The information in this user manual is subject to change due to product updates or other reasons. This guide cannot replace the product labels or the safety precautions in the user manual unless otherwise specified. All descriptions in the manual are for guidance only.

CONTENT

- 1 About This Manual 01**
 - 1.1 Applicable Model..... 01
 - 1.2 Target Audience 01
 - 1.3 Symbol Definition..... 01
 - 1.4 Updates 02
- 2 Safety Precaution 01**
 - 2.1 General Safety 01
 - 2.2 Battery Safety 02
 - 2.3 Emergency Measures 04
 - 2.4 EU Declaration of Conformity..... 04
- 3 Product Introduction 05**
 - 3.1 Product Overview..... 05
 - 3.2 Application Scenarios 07
 - 3.3 Appearance..... 08
- 4 Check and Storage 10**
 - 4.1 Check Before Receiving..... 10
 - 4.2 Deliverables 10
 - 4.3 Storage 11
- 5 System Installation..... 12**
 - 5.1 Installation Requirements..... 12
 - 5.2 Installing the Battery System 14
 - 5.2.1 Moving the Equipment 14
 - 5.2.2 Installing the Battery System..... 14
- 6 Electrical Connection..... 17**
 - 6.1 Safety Precaution 17
 - 6.2 Electrical Connection 18
 - 6.3 Connecting the PE cable..... 19
 - 6.4 Connecting the Power Cable 20
 - 6.5 Connecting the Communication Cable 21
- 7 System Operation 23**
 - 7.1 Check Before Power ON 23
 - 7.2 Power On..... 23
 - 7.3 Setting the Battery Parameters..... 24
 - 7.4 Indicator Status..... 26

- 8 Maintenance 27**
 - 8.1 Power OFF the Battery System 27
 - 8.2 Routine Maintenance 28
 - 8.3 Common Problem Handling 28
 - 8.4 System Troubleshooting 29
- 9 Technical Parameters..... 31**

1 About This Manual

This manual describes the product information, installation, electrical connection, commissioning, troubleshooting, and maintenance. Read through this manual before installing and operating the product. All the installers and users have to be familiar with the product features, functions, and safety precautions. This manual is subject to update without notice. For more product details and latest documents, visit <https://en.goodwe.com>.

1.1 Applicable Model

This manual applies to the listed model below:



- LX F9.6- H-20
- LX F12.8- H-20
- LX F16.0- H-20
- LX F19.2- H-20
- LX F22.4- H-20
- LX F25.6- H-20
- LX F28.8- H-20

1.2 Target Audience

This manual applies to trained and knowledgeable technical professionals only. The technical personnel has to be familiar with the product, local standards, and electric systems.

1.3 Symbol Definition

Different levels of warning messages in this manual are defined as follows:

 DANGER
Indicates a high-level hazard that, if not avoided, will result in death or serious injury.
 WARNING
Indicates a medium-level hazard that, if not avoided, could result in death or serious injury.
 CAUTION
Indicates a low-level hazard that, if not avoided, could result in minor or moderate injury.
NOTICE
Highlights key information and supplements the texts. Or some skills and methods to solve product-related problems to save time.

1.4 Updates

The latest document contains all the updates made in earlier issues.

V1.1 2023-10-30

- The installation position of the terminal resistor has been updated from being placed in the accessory package to being built-in at the communication port.
- Added the Section 8.4 System Troubleshooting

V1.0 2023-05-20

- First Issue

2 Safety Precaution

Please strictly follow these safety instructions in the user manual during the operation.

NOTICE

The System is designed and tested to strictly comply with related safety rules. Read and follow all the safety instructions and cautions before any operations. Improper operation might cause personal injury or property damage as the System are electrical equipment.

2.1 General Safety

NOTICE

- The information in this user manual is subject to change due to product updates or other reasons. This guide cannot replace the product labels or the safety precautions in the user manual unless otherwise specified. All descriptions in the manual are for guidance only.
- Before installations, read through the user manual to learn about the product and the precautions.
- All operations should be performed by trained and knowledgeable technicians who are familiar with local standards and safety regulations.
- Use insulating tools and wear personal protective equipment when operating the equipment to ensure personal safety. Wear anti-static gloves, cloths, and wrist strips when touching electronic devices to protect the inverter from damage.
- Strictly follow the installation, operation, and configuration instructions in this guide and user manual. The manufacturer shall not be liable for equipment damage personal injury if you do not follow the instructions. For more warranty details, please visit <https://en.goodwe.com/warranty>.

2.2 Battery Safety



- High voltage exists during the battery system running. Ensure that the equipment has been powered off to avoid the risk of electric shock before operating the device in the system. Strictly follow all safety precautions outlined in this manual and safety labels on the equipment during the operation.
- The battery used with the inverter shall be approved by the inverter manufacturer. The approved battery list can be obtained through the official website.
- Do not disassemble, modify, or replace any part of the battery without official authorization from the manufacturer. Otherwise, it may cause electrical shock or damages to the equipment for which the manufacturer shall not be held responsible.
- Do not hit, pull, drag, squeeze or step on the System or put the battery into fire. Otherwise, the battery may explode.
- Do not place the battery in a high temperature environment. Make sure that there is no direct sunlight and no heat source near the battery. When the ambient temperature exceeds 60 °C, it may cause fire.
- Do not use the battery module or power control unit if it is defective, broken, or damaged. Damaged battery modules may leak electrolyte.
- To protect the battery pack and its components from damage during transportation, please ensure that the transportation personnel are professionally trained. All operations during the transportation have to be recorded. The equipment shall be kept in balance to avoid falling down.
- Consider the weight of the equipment before moving it. Assign enough personnel to move the equipment to avoid personal injury.
- Contact after-sale service immediately if the battery is not able to be started. Otherwise, the battery might be damaged permanently.
- Do not move the battery when it is working. Contact after-sales service if the battery shall be replaced or added.

 CAUTION	
<ul style="list-style-type: none"> • Protect the battery system from damage during transportation and storage. • The transportation must be carried out by trained professionals. All operations during the process have to be recorded. • Keep the equipment stable to avoid dumping, which can result in equipment damage and personal injuries. • Place the cables at least 30mm away from the heating components or heat sources, otherwise the insulation layer of the cables may be aging or broken due to high temperature. • Tie the same type cables together, and place cables of different types at least 30mm apart. Do not place the cables entangled or crossed. 	

Label Description

	Potential risks exist. Wear proper Personnel Protective Equipment before any operations.		Install the equipment away from open flames or fire sources.
	HIGH VOLTAGE HAZARD High voltage exists during the equipment's running. Ensure the equipment is power off before any operations.		Keep the equipment away from children.
	Operate the equipment properly to avoid explosion.		Do not lift the equipment after the wiring is completed or when the equipment is working.
	The equipment contains corrosive electrolytes. In case of a leak in the equipment, avoid contact the leaked liquid or gas.		Do not disconnect or plug and unplug the DC connectors during the operation of the equipment.
	The battery contains flammable materials, beware of fire.		Recycle regeneration mark.
	Read through the user manual before any operations.		CE Mark
	Pay attention to wear personal protective equipment during installation, operation and maintaining of the equipment.		Grounding point.
	Do not dispose of the equipment with household garbage at its end of life. Dispose it according to local laws and regulations or send it to the manufacturer.	-	-

2.3 Emergency Measures

Battery Electrolyte Leakage

If the battery module leaks electrolyte, avoid contact with the leaking liquid or gas. The electrolyte is corrosive. It will cause skin irritation or chemical burn to the operator. Anyone contact the leaked substance accidentally has to do as following:

- **Breath in the leaked substance:** Evacuate from the polluted area, and seek immediate medical assistance.
- **Eye contact:** Rinse your eyes for at least 15 minutes with clean water and seek immediate medical assistance.
- **Skin contact:** Thoroughly wash the touch area with soap and clean water, and seek immediate medical assistance.
- **Ingestion:** Induce vomiting, and seek immediate medical assistance.

Fire

- The battery may explode when the ambient temperature exceeds 150°C. Poisonous and hazard gas may be released if the battery is on fire.
- In the event of a fire, please make sure that the carbon dioxide extinguisher or Novec1230 or FM-200 is nearby.
- The fire cannot be put out by water or ABC dry powder extinguisher. Firefighters are required to wear full protective clothing and self-contained breathing apparatus.

2.4 EU Declaration of Conformity

GoodWe Technologies Co., Ltd. hereby declares that the product without wireless communication modules sold in the European market meets the requirements of the following directives:

- Electromagnetic compatibility Directive 2014/30/EU (EMC)
- Electrical Apparatus Low Voltage Directive 2014/35/EU (LVD)
- Battery Directive 2006/66/EC and Amending Directive 2013/56/EU
- Waste Electrical and Electronic Equipment 2012/19/EU
- Registration, Evaluation, Authorization and Restriction of Chemicals (EC) No 1907/2006 (REACH)

3 Product Introduction

3.1 Product Overview

Intended usage

The battery system, which consists of a power control unit (PCU for short) and battery modules, can store and release the electric energy according to the requirements of the solar energystorage system. The input and output ports of the energy storage system are high voltage direct current ports.

Model Description

This manual applies to the listed battery below:

- LX F9.6- H-20
- LX F12.8- H-20
- LX F16.0- H-20
- LX F19.2- H-20
- LX F22.4- H-20
- LX F25.6- H-20
- LX F28.8- H-20

Model

LX F9.6-H-20



1 2 3 4

No.	Referring to	Description
1	Series code	Lynx Home F Series
2	Usable energy	<ul style="list-style-type: none"> • 9.6: the usable energy of the battery system is 9.6kWh. • 12.8: the usable energy of the battery system is 12.8kWh. • 16.0: the usable energy of the battery system is 16.0kWh. • 19.2: the usable energy of the battery system is 19.2kWh. • 22.4: the usable energy of the battery system is 22.4kWh. • 25.6: the usable energy of the battery system is 25.6kWh. • 28.8: the usable energy of the battery system is 28.8kWh.
3	Product Features	H: high voltage battery
4	Version code	20: version of the battery system is 2.0.

Usable energy

NOTICE

- The battery system supports capacity expansion. A maximum of nine battery modules can be used to extend the usable energy of the battery system. Expand the battery system capacity in strict compliance with the expansion requirements. Contact the dealer or manufacturer for more details. Failure to follow the requirements may result in an undervoltage, over-voltage or voltage difference fault in the battery system.
- Actual height varies slightly. Refer to the actual installation height.

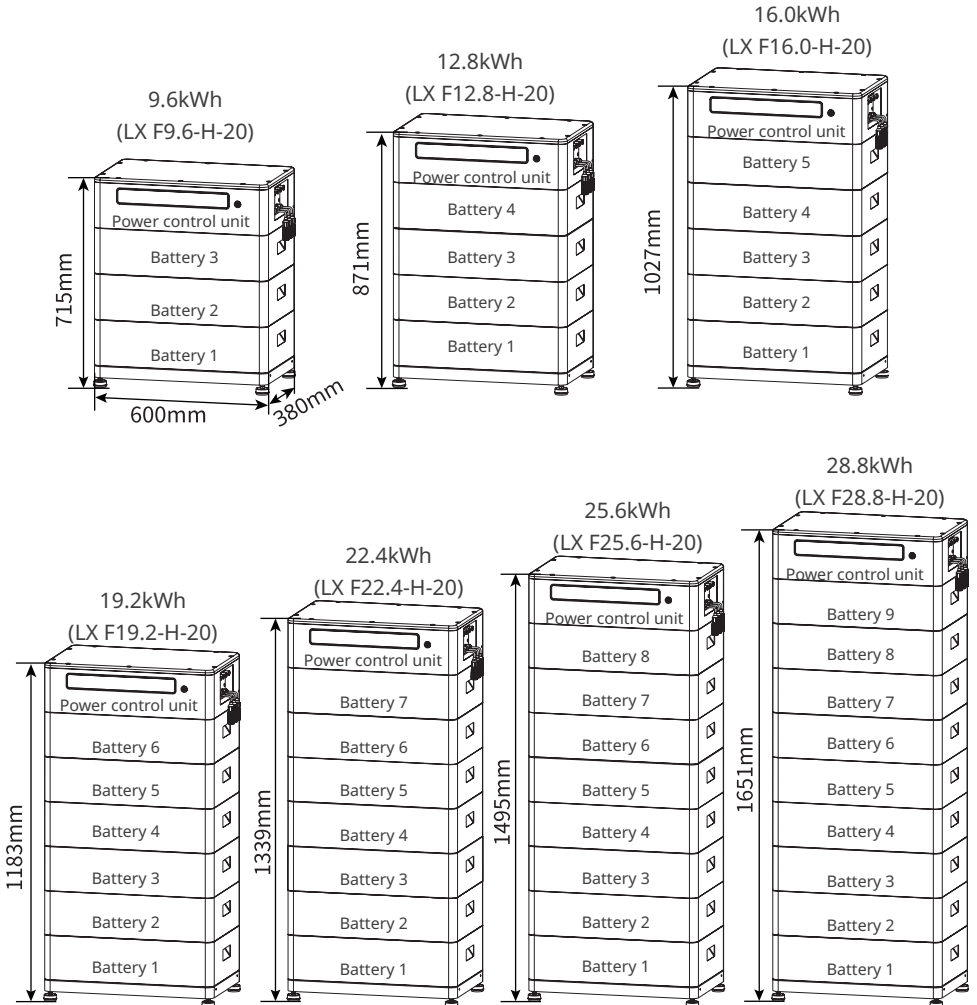

3.2 Application Scenarios

NOTICE

- A max of eight battery systems can be parallel connected in one energy storage system. Ensure that the usable energy of each battery system is the same.
- Install the circuit breaker between the inverter and the battery and the circuit breaker between the two battery systems in compliance with local laws and regulations. Recommended specifications:
 - Nominal voltage $\geq 750V$
 - When a single battery system is applied, the nominal current of the battery: $\geq 50A$.
 - When two battery systems are applied, the nominal current of the battery: $\geq 100A$.
 - When three or more battery systems are applied, the nominal current of the battery: $\geq 125A$.

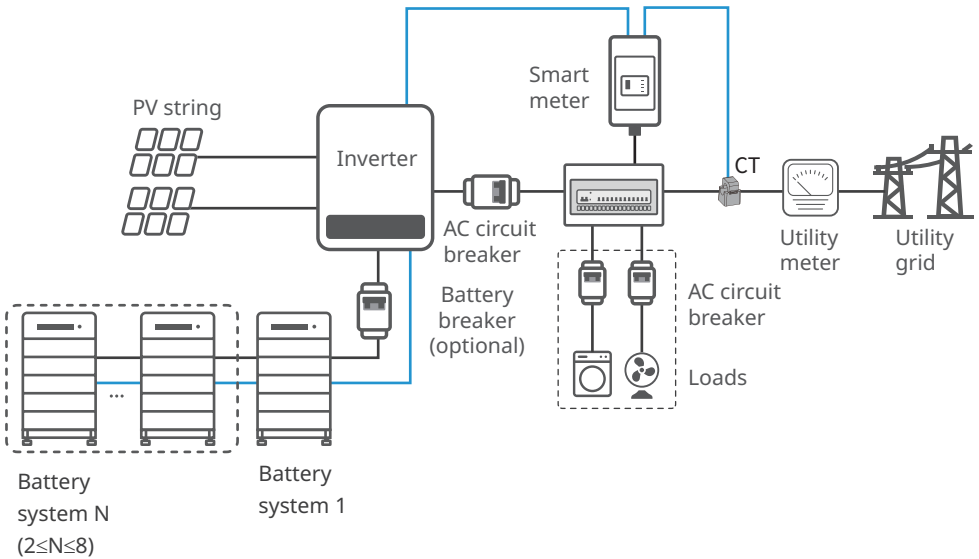

Approved inverter list

Scan the QR code below or visit the official website to get the Approved Battery Options Statement.



GoodWe
Inverter



GE
Inverter

3.3 Appearance

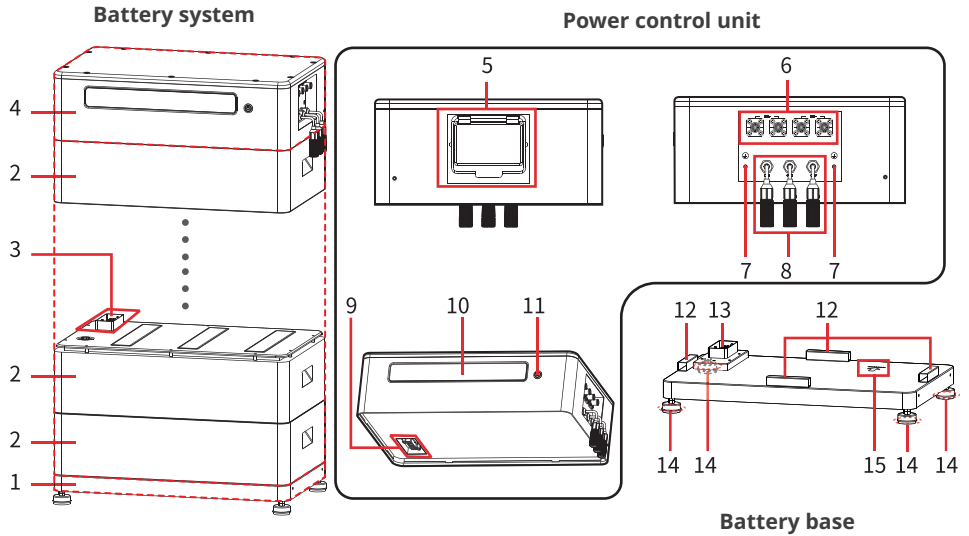

No.	Parts	Description
1	Battery base	-
2	Battery module	3 to 9 battery modules can be connected in the battery system.
3	Battery serial connection interface	Connects the battery module to the next module or to the power control unit.
4	Power control unit	Controls battery system.
5	Battery system switch	Switches the battery system on or off.
6	DC cable port (BAT)	Connects the DC cables of the battery system to the inverter. Includes two BAT+ ports and two BAT- ports. The two BAT+ or BATport are functionally identical.
7	Grounding point	Connects grounding cables to the grounding points for protection.
8	Communication terminal (COM)	Connects the communication cable between the battery and inverter or two batteries. COM3 is reserved.

No.	Parts	Description
9	Power control unit serial connection interface	Connects the power control unit to a battery module.
10	SOC indicator	<ul style="list-style-type: none"> • SOC indicator: indicates the SOC status of the battery. • Multi-function button indicator
11	Multi-function button indicator	<ul style="list-style-type: none"> • Black start button: When there is no PV power generation in the PV system and the power grid is abnormal, long press the multi-function button for 5s to 10s, and then release it to start the battery system. Use the battery power to provide starting voltage for the inverter, thereby enabling the inverter to enter off-grid mode for operation. • Long press the multi-function button for 15s to power off the battery system. • Combines the SOC indicator and multi-function button indicator to check the battery system working status, alarm status and fault status.
12	Battery installation limit	Fix the battery to prevent it from tilting.
13	Battery base serial connection interface	Connects the power control unit to a battery module.
14	Adjustable feet	Adjusts the distance between the battery base and the ground.
15	Direction arrow for battery base	Ensure that the arrow in the battery base points towards the wall when installing the battery base.

4 Check and Storage









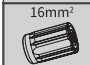

4.1 Check Before Receiving

Check the following items before receiving the product.

1. Check the outer packing box for damage, such as holes, cracks, deformation, and other signs of equipment damage. Do not unpack the contents from the box and contact the supplier as soon as possible if any damage is found.
2. Check the outer packing box for damage, such as holes, cracks, deformation, and other signs of equipment damage. Do not unpack the package and contact the supplier as soon as possible if any damage is found.
3. Check the deliverables for correct model, complete contents, and intact appearance. Contact the supplier as soon as possible if any damage is found.

4.2 Deliverables

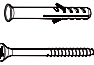
Power control unit

				
PCU x 1	Battery base x 1	Waterproof plug for DC connector (6mm ²) x 4	Waterproof plug for DC connector (16mm ²) x 4	DC Connector <ul style="list-style-type: none"> • Positive x 2 • Negative x 2
				
Documents x 1	M5*12 screw x 8	Adjustable feet x 4	M6 screw x 2	Grounding terminal x 2
				
Expansion bolt x 8	Locking bracket x 8			

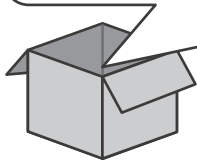

Battery module

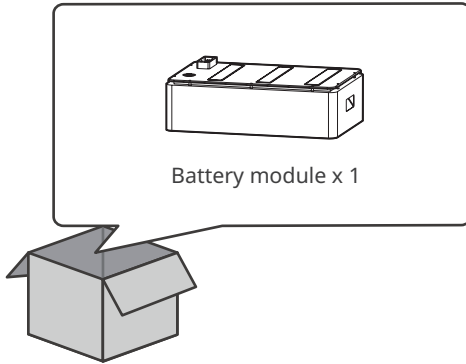

4.3 Storage

If the equipment is not to be installed or used immediately, please ensure that the storage environment meets the following requirements:

1. Do not unpack the outer package or throw the desiccant away.
2. Complete the equipment installation in three days after unpacking it. Pack and store the equipment using the original packing box if it is not installed.
3. Stack the equipment complying with the labels and requirements on the packing box.
4. The equipment must be stacked with caution to prevent them from falling.
5. Keep the equipment away from flammable, explosive, and corrosive matters.
6. Place the equipment in a cool place where away from direct sunlight.
7. Store the equipment in a clean place. Make sure the temperature and humidity are appropriate and no condensation.
8. Storage SOC: 25%~50% SOC. Circle the charge-discharge every 6 months.
9. Storage temperature (T):
 - When $-20^{\circ}\text{C} \leq T < 0^{\circ}\text{C}$, the storage period cannot exceed 1 month.
 - When $0^{\circ}\text{C} \leq T \leq 35^{\circ}\text{C}$, the storage period cannot exceed 1 year.
 - When $35^{\circ}\text{C} < T \leq 45^{\circ}\text{C}$, the storage period cannot exceed 1 month.
10. Recommended storage humidity: 0%~95%RH (no condensation). Do not install the battery system if there is any moisture or condensation.

5 System Installation

5.1 Installation Requirements

Installation Environment Requirements

1. Do not install the equipment in a place near flammable, explosive, or corrosive materials.
2. Do not install the equipment in a place that is easy to touch, especially within children's reach. High temperature exists when the equipment is working. Do not touch the surface to avoid burning.
3. Avoid the water pipes and cables buried in the wall when drilling holes.
4. Install the equipment in a sheltered place to avoid direct sunlight, rain, and snow. Build a sunshade if it is needed.
5. The place to install the equipment shall be well-ventilated for heat dissipation and large enough for operations.
6. The equipment with a high ingress protection rating can be installed indoors or outdoors. The temperature and humidity at the installation site should be within the appropriate range.
7. Install the equipment at a height that is convenient for operation and maintenance, electrical connections, and checking indicators and labels.
8. The altitude to install the equipment shall be lower than the maximum working altitude 3000m.
9. Install the equipment away from electromagnetic interference. Install the product away from electromagnetic interference. If there is any radio or wireless communication equipment below 30MHz near the equipment, make sure that the inverter is at least 30m far away from the wireless equipment.



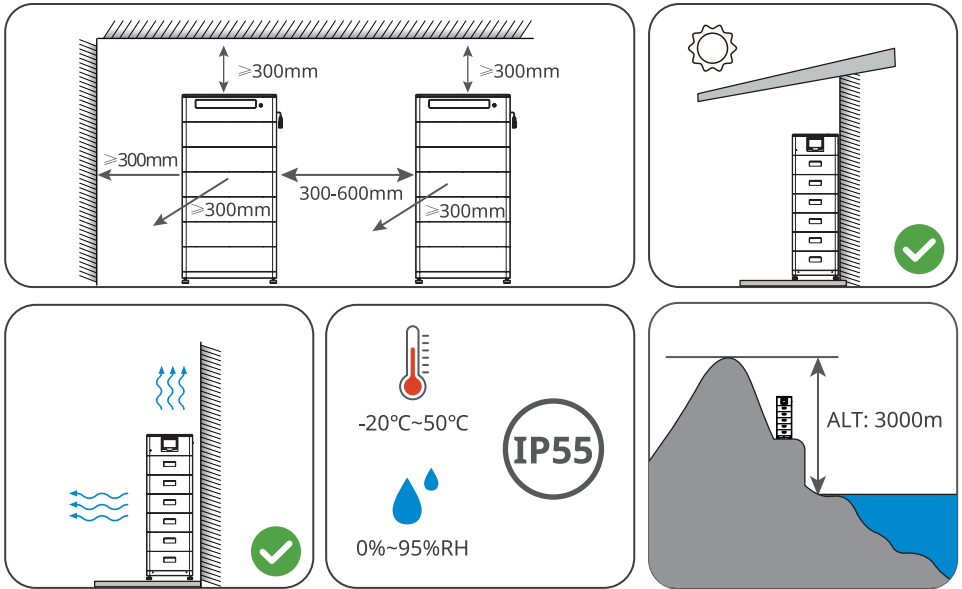

Mounting Support Requirements

- The mounting support shall be nonflammable and fireproof.
- Install the equipment on a surface that is solid enough to bear the product weight.
- Put the battery system near the wall and install the locking brackets to prevent the battery from falling down.

Installation Angle Requirements

- Install the equipment vertically, no tilt or upside down.

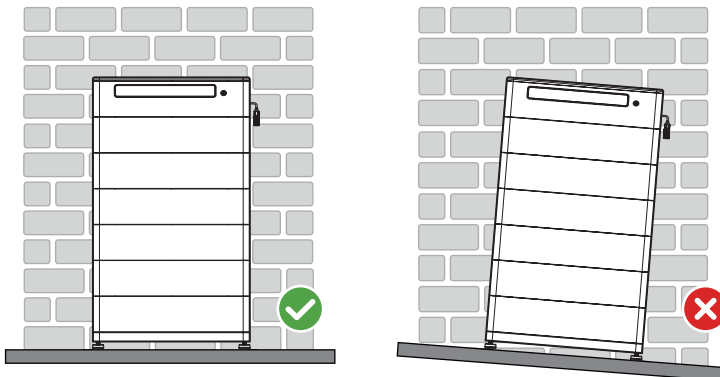

5.2 Installing the Battery System

5.2.1 Moving the Equipment

CAUTION

- Operations such as transportation, shipment, installation and so on shall in compliance with the laws and regulations of the country or region where the inverter is located.
- Move the equipment to the site before installation. Follow the instructions below to avoid personal injury or equipment damage.
 1. Consider the weight of the equipment before moving it. Assign enough personnel to move the equipment to avoid personal injury.
 2. Wear safety gloves to avoid personal injury.
 3. Keep balance to avoid falling down when moving the equipment.

5.2.2 Installing the Battery System

WARNING

- Ensure that the PCU is installed above the battery modules. Do not install any battery modules above the PCU.
- Ensure that the battery system is installed vertically and securely. Align the installation holes of the battery base, battery modules, and PCU. Put the locking bracket cling to the wall, ground, and the battery system.
- Cover the battery system with a cardboard to prevent foreign matters when drilling holes, which may damage the system.
- Remove the cover of the battery module's connection port before installing the battery system.

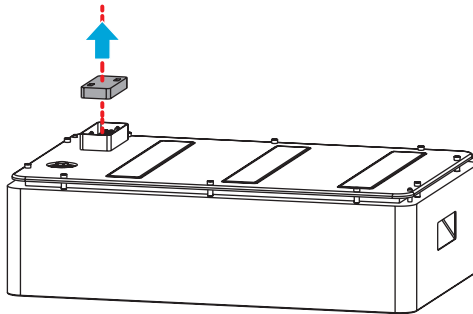

Step 1: Install the adjustable feet to the base.

Step 2: Install the locking bracket to the base.

Step 3: Place the base cling to the wall and mark the drilling positions. Then remove the base.

Step 4: Drill holes using the hammer drill.

Step 5: Check the battery base and ensure that the narrow on the base points to the wall.

Step 6: Screw the expansion bolts to fix the base.

Step 7: Install the remaining batteries and PCU based on the actual needs.

Step 8: Secure the locking bracket to prevent the PCU from falling down.

Step 9: Check whether the battery system is vertical and secure. Adjust the battery system by the adjust feet if the system is tilted or swayed.

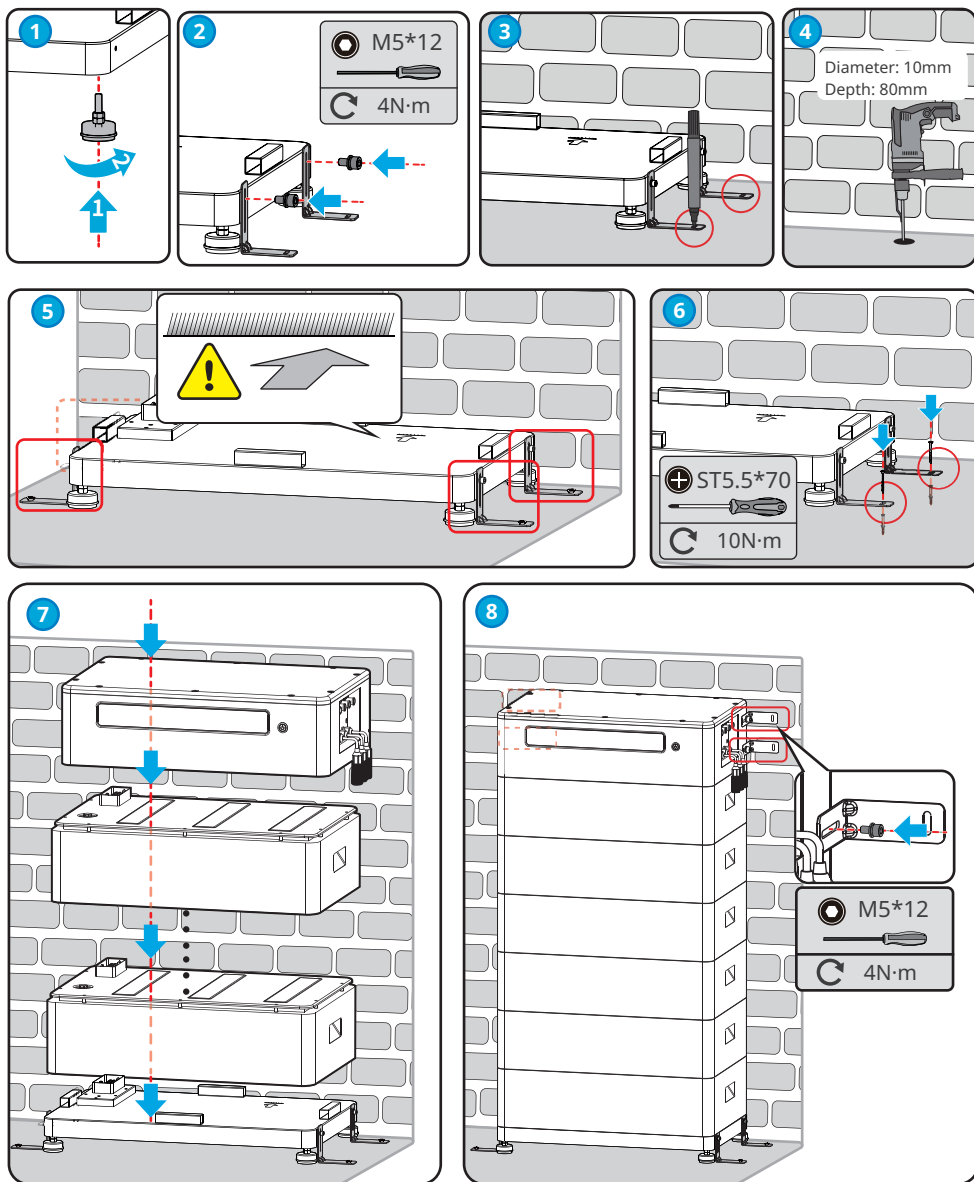

! WARNING

- Remove the PCU after marking the drilling positions to avoid damage to the unit when drilling holes using the drill.
- Cover the battery system with a cardboard to prevent foreign matters when drilling holes, which may damage the system.

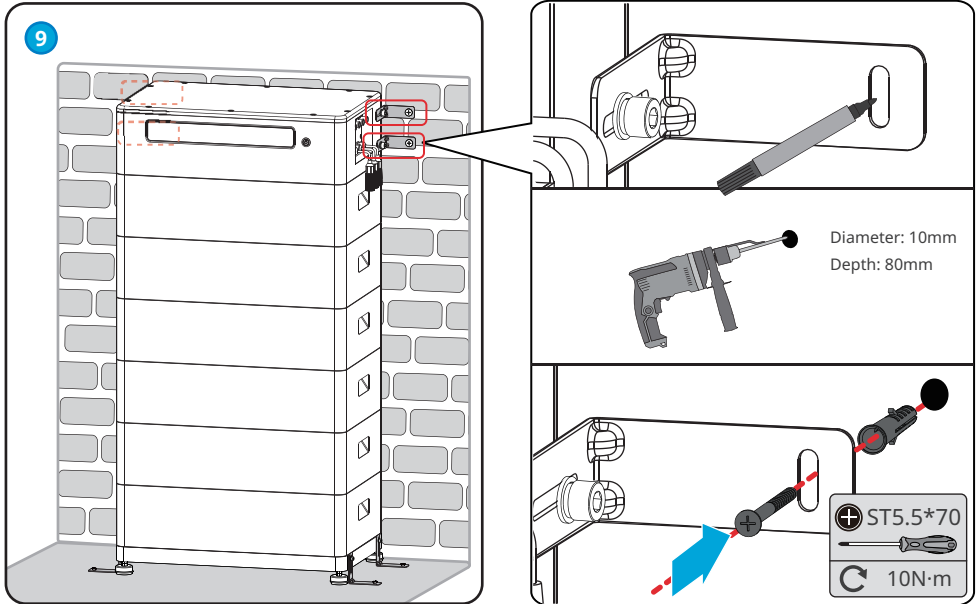

6 Electrical Connection

6.1 Safety Precaution

DANGER

- High voltage exists during the battery system running. Ensure that the equipment has been powered off to avoid the risk of electric shock before operating the device in the system. Strictly follow all safety precautions outlined in this manual and safety labels on the equipment during the operation.
- All operations, cables and parts specification during the electrical connection shall be in compliance with local laws and regulations.
- Tie the cables of the same type together, and place cables of different types apart. Do not place the cables entangled or crossed.
- Make sure that the cable conductor is in full contact with the terminal and the cable insulation part is not crimped with the terminal when crimping the terminal. Otherwise, the inverter may not be able to work properly, or the connection may be unreliable during working, which may cause terminal block damage, etc.

NOTICE

- Wear personal protective equipment like safety shoes, safety gloves, and insulating gloves during electrical connections.
- All electrical connections should be performed by qualified professionals.
- Cable colors in this document are for reference only. The cable specifications shall meet local laws and regulations.

6.2 Electrical Connection

Single Battery System

NOTICE

- Please ensure that the COM1 communication port is connected to the inverter, and the COM2 communication port is equipped with a terminal resistor when the PCU leaving the factory. The battery system cannot work properly if the termination resistor is not installed.
- The COM3 port is reserved. Do not connect any cable to the port.

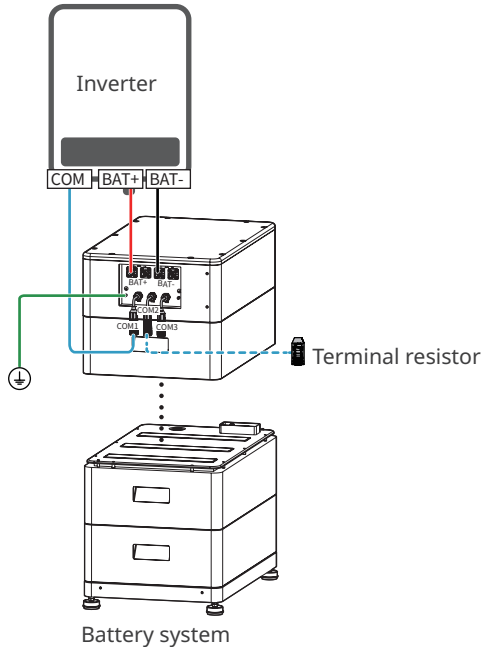

Parallel Connected Battery Systems

NOTICE

- A max of eight battery systems can be parallel connected in one energy storage system. Ensure that the usable energy of each battery system is the same.
- Please ensure that the COM1 communication port of battery system 1 is connected to the inverter, and the COM2 communication port is used for battery connection. The COM2 of the PCU has installed terminal resistors when leaving factory. If you need to connect communication cables, please remove the terminal resistors. If the COM2 port of battery system N is not equipped with terminal resistor, it will cause the battery system to not function properly.
- The COM3 port is reserved. Do not connect any cable to the port.

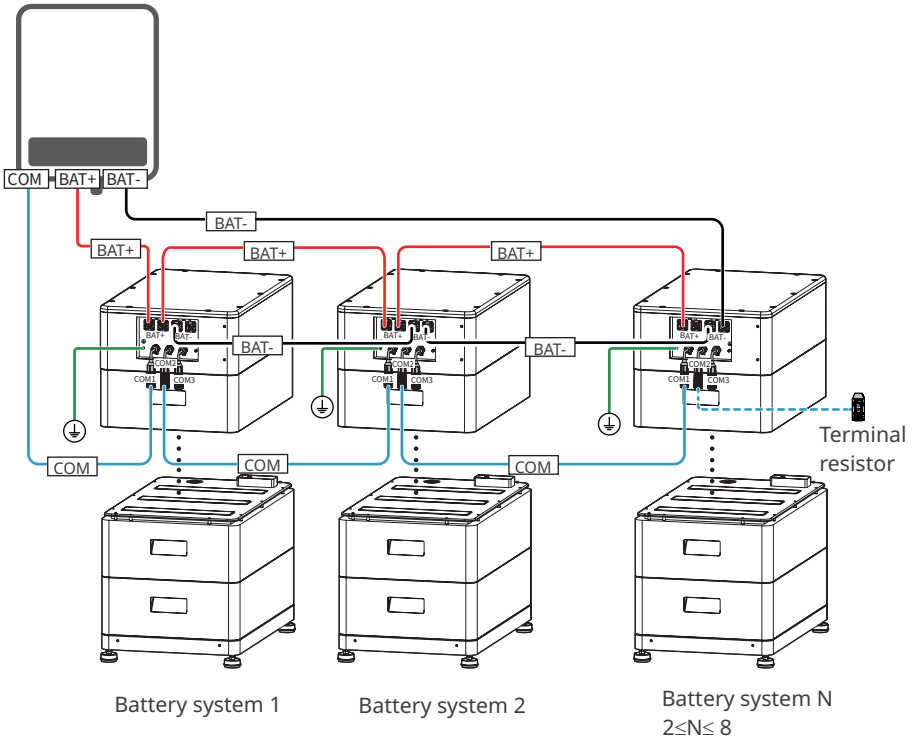

6.3 Connecting the PE cable

NOTICE

- Connect the PE cable first before installing the equipment. Disconnect the PE cable before dismantling the equipment.
- Make sure that the drawing force of the cable after crimping is greater than 400N.
- The PE cable should be prepared by the customer. Recommended specifications:
 - Type: single-core outdoor copper cable
 - Cross-sectional area: 4-6mm²

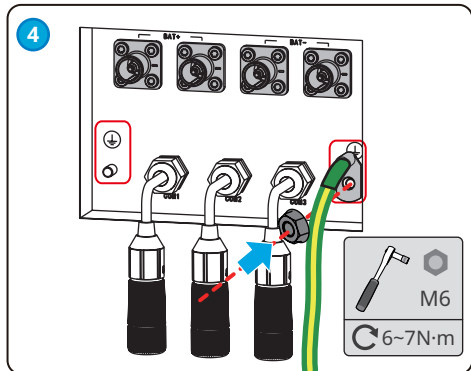
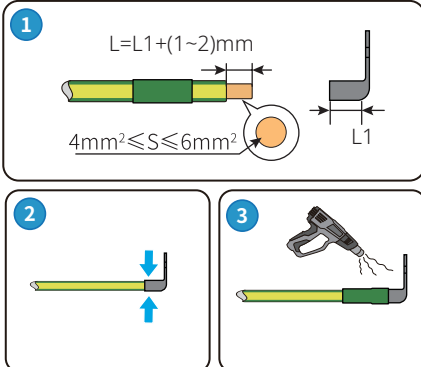

6.4 Connecting the Power Cable



WARNING

- The DC cable should be prepared by the customer. Recommended specifications:
 - Type: single-core outdoor copper cable
 - Conductor cross-sectional area S: $S=6\text{mm}^2$ or $S=16\text{mm}^2$
- When the cross-sectional area range of the conductor is 6mm^2 , a 6mm^2 DC connector (included in the deliverables) should be used. The drawing force of the cable after crimping should be greater than 500N. DC cables in this range can only be used to connect a single battery system. Do not cluster battery systems together as this may result in damage to the system.
- When the cross-sectional area range of the conductor is 16mm^2 , a 16mm^2 DC connector (included in the deliverables) should be used. The drawing force of the cable after crimping should be greater than 500N.
- It is recommended to use a YQK-70 hydraulic plier to crimp the DC terminal of the battery. When the cross-sectional area of the conductor is 6mm^2 , the crimping dies with an "8" should be used, when the cross-sectional area of the conductor is 16mm^2 , the crimping dies with an "16" should be used.
- If the recommended hydraulic plier cannot be purchased, please choose the crimping tool according to the terminal size to ensure that the crimped terminals meet the usage requirements.
- Do not remove the cover of the DC cable port if the DC cable is not to be connected. Otherwise, the protection degree may be influenced.

Crimping size

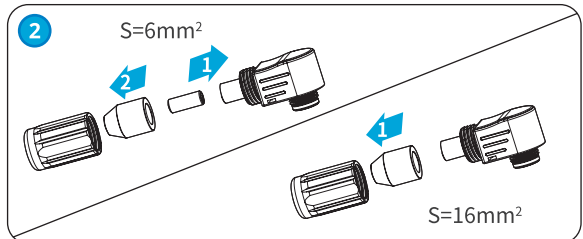
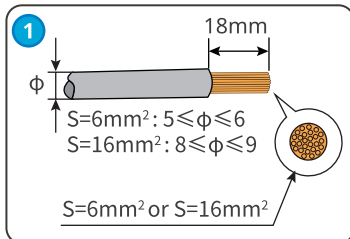
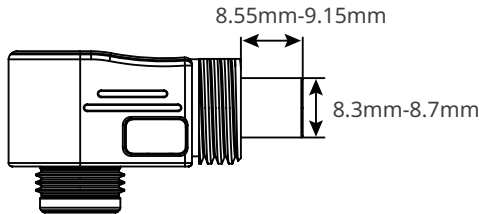

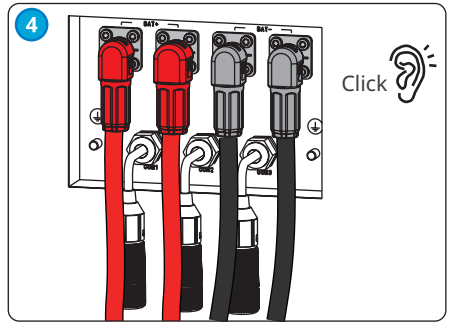
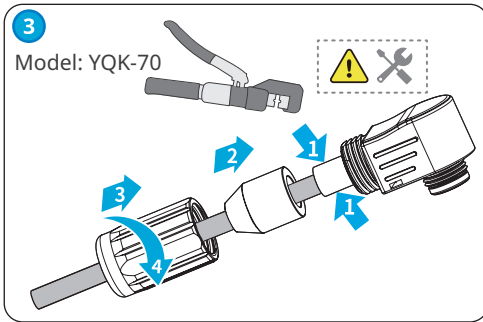

6.5 Connecting the Communication Cable

 **WARNING**

- If the communication cable between the inverter and the battery system is supplied by the inverter manufacturer, you can decide whether to use the supplied cable or not according to the actual situation. Refer to the user manual of the inverter for detailed cable specifications.
- When making communication cables, please ensure that the definition of the battery communication port matches the definition of the inverter communication port. Otherwise, it will cause communication failure.
- If you need to prepare the communication cable, the recommended specifications are: standard network cable and RJ45 connector.

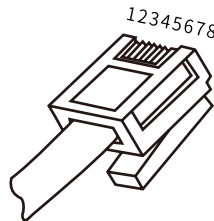

Port Definition

PIN	COM1	COM2	Description
1	RS485A	RS485A	Connecting external communication devices via RS485.
2	RS485B	RS485B	
3	-	-	Reserved
4	CAN_1H	CAN_1H	Connecting the inverter communication port or battery parallel communication port
5	CAN_1L	CAN_1L	
6	DI7H-	DI7H-	Detects the cluster signal of the battery system.
7	DI7H+	DI7H+	
8	-	PWM	Sending paralleled PWM signals.

WARNING

- Detailed requirements for communication cable connection and termination resistor installation can be obtained in the system wiring network. This chapter only describes the connection method of communication cables and port definitions.
- If the termination resistor is not installed, the Interlock Failure will occur, and the battery system cannot work correctly.

Connecting the Communication Cable

Step 1: Disassemble the waterproof module.

Step 2: Run the communication cable through the waterproof module.

Step 3: Connect the communication cable to the battery system. Tighten the waterproof module.

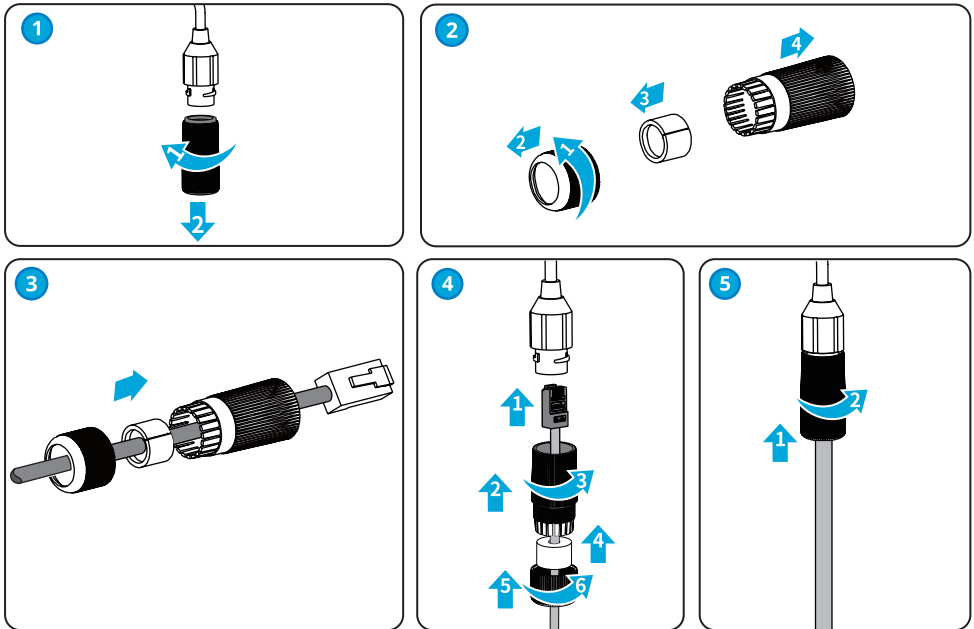

(Optional) Removing the Termination Resistor

Step 1: Disassemble the waterproof module.

Step 2: Remove the termination resistor.

Step 3: Tighten the waterproof module.

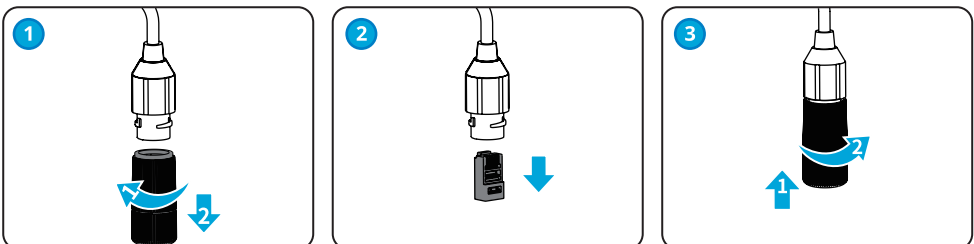

7 System Operation

7.1 Check Before Power ON

Check the following items before power on to avoid the battery system being damaged.

No.	Check Item
1	The system is firmly installed in a clean place where is well-ventilated and easy to operate.
2	The PE cable, power cable, communication cable, and termination resistor are connected correctly and securely.
3	Cable ties are intact, routed properly and evenly.
4	Unused ports and terminals are sealed.

7.2 Power On

NOTICE

- The equipment in the dashed boxes are optional.
- Install the circuit breaker between the inverter and the battery and the circuit breaker between the two battery systems in compliance with local laws and regulations.
- Strictly follow the power on requirements to avoid damaging the system.
- To ensure effective protection, the cover of the battery system switch should remain closed. The cover can be closed automatically after being opened. Fasten the cover with screws if the switch is not to be used for a long-term period.

Method I:

Step 1: Turn on the breaker between the inverter and the battery system.

Step 2: (Optional) Turn on the breaker between the battery systems if they are clustered.

Step 3: Turn on the battery system switch. Turn on the switches of the battery systems in turn if they are clustered.

Step 4: Turn on the inverter in the system following the instructions in the user manual of the inverter.

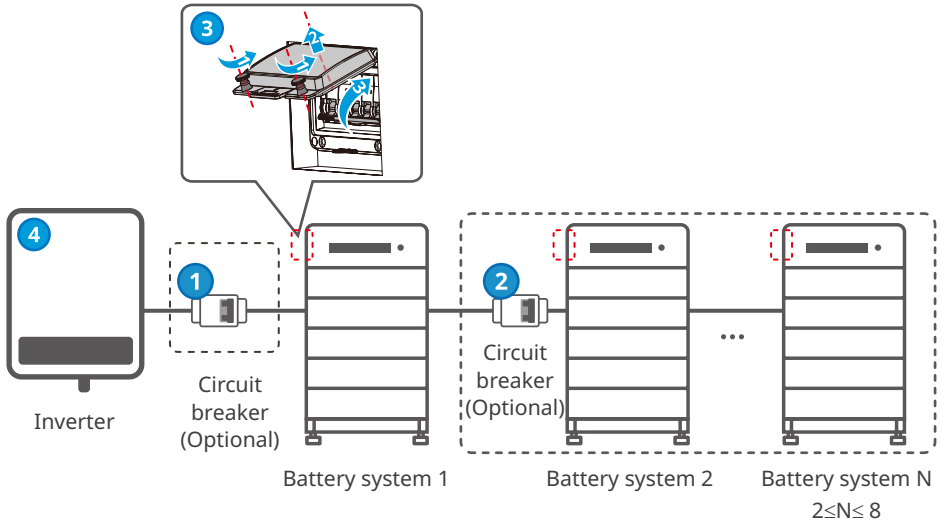

NOTICE

- Black start button: When there is no PV power generation in the PV system and the power grid is abnormal, long press the multi-button for 5s to 10s, and then release it to start the battery system. Use the battery power to provide starting voltage for the inverter, thereby enabling the inverter to enter off-grid mode for operation.
- After the battery system is started, set the battery model through SolarGo App within 10 minutes to ensure normal communication between the inverter and the battery.

Method II:

Step 1: Long press the multi-function button on the PCU for 5s to 10s, then release it to start the battery system. If it is a parallel battery system, long press the multi-function button of the battery system in sequence.

Step 2: Turn on the inverter in the system following the instructions in the user manual of the inverter.

7.3 Setting the Battery Parameters

NOTICE

Select the battery model via SolarGo App after powering on the battery system, so that the battery system can work properly.

Step 1: Download SolarGo App.

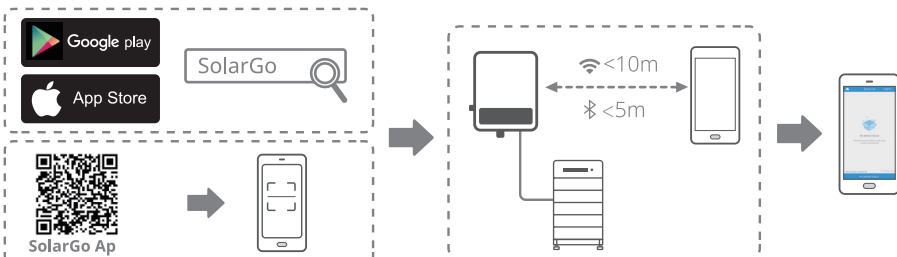

Step 2: Connects inverter to the App.**Step 3:** Tap **Home** > **Parameters** > **Basic Setting** to set the basic parameters. Follow the prompts to select and set the battery model.**NOTICE**

Select the wrong battery model may cause system failure. Ensure that the battery model is right.

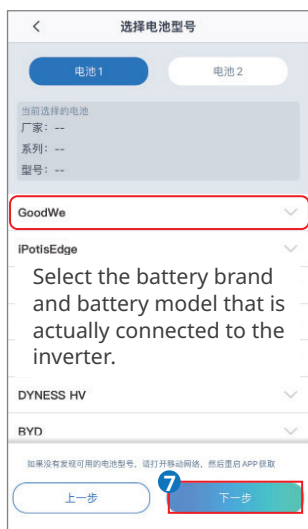

Lynx Home F Series G2

Select the battery brand and battery model that is actually connected to the inverter.



如果没有发现可用的电池型号，请打开移动网络，然后重启 APP 获取

上一步

下一步

7.4 Indicator Status

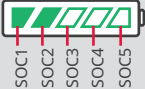
Normal status

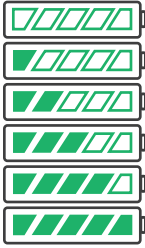
SOC indicator status 	Button Indicator status 	Battery system status
<p>SOC indicator indicates SOC of the battery system.</p> 	<p>Green light blink 1 time/s</p> <p>Green light blink 2 time/s</p> <p>Steady green light</p>	<p>The battery system is in standby status.</p> <p>The battery system is in idle status.</p> <p>The battery system is in charging status. Note: When the battery SOC reaches the limit charging SOC, the charging will stop.</p>
<p>The last SOC indicator blinks 1 time/s.</p> <ul style="list-style-type: none"> When $5\% \leq \text{SOC} < 25\%$, SOC 1 blinks. When $25\% \leq \text{SOC} < 50\%$, SOC 2 blinks. When $50\% \leq \text{SOC} < 75\%$, SOC 3 blinks. When $75\% \leq \text{SOC} < 95\%$, SOC 4 blinks. When $95\% \leq \text{SOC} \leq 100\%$, SOC 5 blinks. 	<p>Steady green light</p>	<p>The battery system is in discharging status. Note: When the system does not need to supply power to the load or the battery SOC is below the set discharge depth, the battery will no longer discharge.</p>

Abnormal status

Button indicator 	Battery system status	Solutions
<p>Red light blink 2 times/s</p>	<p>Battery system alarm</p>	<p>Once an alarm occurs, the battery system will perform a self-check. After the battery system self-check is complete, the battery system enters operation or fault mode.</p>
<p>Steady red light</p>	<p>Battery system fault</p>	<p>Check both the button indicator and the SOC indicator status to determine the fault that has occurred and handle the problem follow the methods recommended in the Troubleshooting section.</p>

8 Maintenance

8.1 Power OFF the Battery System

DANGER

- Power off the battery system before operations and maintenance. Otherwise, the equipment may be damaged or electric shocks may occur.
- Strictly follow the power off requirements to avoid damaging the system.

NOTICE

- The equipment in the dashed boxes are optional.
- Install the circuit breaker between the inverter and the battery and the circuit breaker between the two battery systems in compliance with local laws and regulations.
- To ensure effective protection, the cover of the battery system switch should remain closed. The cover can be closed automatically after being opened. Fasten the cover with screws if the switch is not to be used for a long-term period.

Method I:

Step 1: Turn off the inverter in the system following the instructions in the user manual of the inverter.

Step 2: Turn off the circuit breaker between the inverter and the battery.

Step 3:(Optional) Turn off the breakers between the battery systems if they are clustered.

Step 4: Turn off the battery system switch. Turn off the switches of the battery systems in turn if they are clustered.

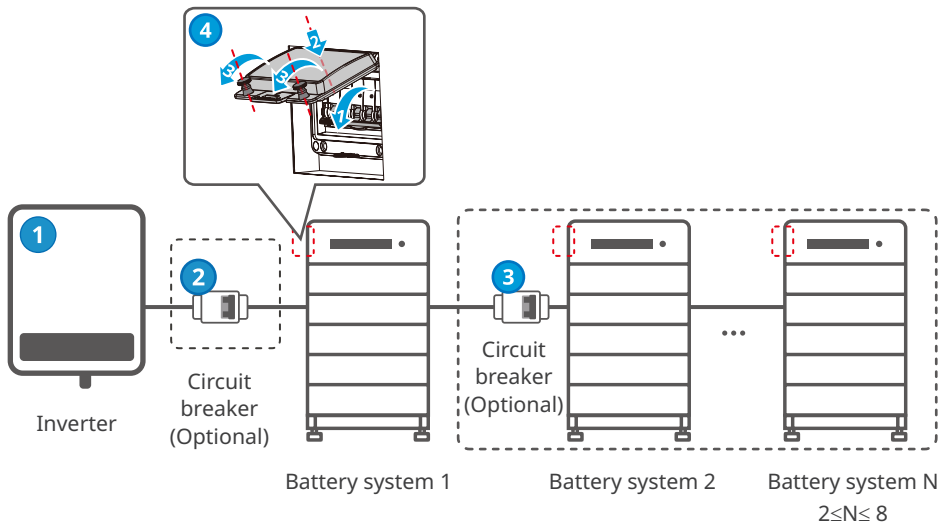

Method II:

Step 1: Turn off the inverter in the system following the instructions in the user manual of the inverter.

Step 2: Long press the multi-function button indicator for more than 15s and release it, make sure that the SOC indicator and multi-function button indicator of the PCU are off.

8.2 Routine Maintenance**WARNING**

- Contact the after-sales service for help if you find any problems that may influence the battery or the hybrid inverter. Disassemble without permission is strictly forbidden.
- Contact after-sale service for help if the copper conductor is exposed. Do not touch or disassemble privately because the high voltage danger exists.
- In case of other emergencies, contact the after-sales service as soon as possible. Operate following the instructions or wait for the after-sales service personnel.

Maintaining Item	Maintaining Period
Check whether the locking bracket is secured, tighten it if not.	Once every 6 months
Check whether the outer enclosure is broken. Repair the painting or contact the after-sales service if there is any broken.	Once every 6 months
Check whether the cables are exposed. Replace the exposed cable or contact the after-sales service for help.	Once every 6 months
Check whether there is any dust around the battery module. Clean the dust if there is any to avoid affecting heat dissipation.	Once every 6 months
Check whether there is any liquid or pest near the battery to avoid intrusion in a long term.	Once every 6 months

8.3 Common Problem Handling

Problem	Cause	Solutions
Battery system tilt	The ground is uneven or deformed	1. Adjust the height of the anchor nut. 2. Replace to hard ground.
PCU shaking	The screws of the L-shaped bracket fixing the PCU to the wall are not tightened.	Tighten the L-shaped bracket of the battery system.
The gap between the PCU and the battery module is too large to stack	1. The blind mate connectors of the PCU and battery module in the battery system are not corresponding 2. The cover plate of the battery module wiring port was not removed	1. Adjust the module position to ensure that the PCU and battery modules are stacked without misalignment. 2. Remove the cover plate of the battery module wiring port.
The indicator light goes out and the battery switch trips during operation.	Cable short circuit or internal failure of battery system.	1. Check for short circuits in external cables. 2. Power off and wait for 2 hours, then power on.







<p>The red button indicator light blinks, the SOC light shows battery level, and there is no "click" sound when the relay is closed</p>	<ol style="list-style-type: none"> 1. Communication fault. 2. Battery model setting error in SolarGo APP. 	<ol style="list-style-type: none"> 1. Check if the terminal resistor of COM2 port is installed correctly. 2. Check if the communication cables are correct. 3. Check if the inverter is working properly. 4. Set the battery system model through the SolarGo App. 5. If the problem persists, long press the multi-function button for 5s to 10s then release it, confirm if there is a "click" sound from the relay, and report the situation to the dealer.
---	---	---



















8.4 System Troubleshooting

The battery system may power off automatically and some functions may not work properly once the battery system fails. Perform troubleshooting according to the following methods. Contact the after-sales service if these methods do not work. Collect the information below before contacting the after-sales service, so that the problems can be solved quickly.

1. Battery information, such as: serial number, software version, when the device was installed, when the fault occurred, how often it occurred, etc.
2. Ambient environment, such as: weather conditions and installation environment. Photos, videos and other files can be provided to assist in the analysis of the problem.



SOC indicator status	Fault	Solutions
	Battery Overvoltage	Power off and wait for 2 hours. Contact the after-sale service if the problem persists.
	Battery Undervoltage	Contact the after-sale service.
	High Cell Temperature	<ol style="list-style-type: none"> 1. There are heat sources around the battery system, such as open flames, boilers, or other heating devices. Please keep the battery system away from heat sources. 2. Power off the battery and wait for the temperature to recover before powering it on again. Contact the after-sale service if the problem persists.
	Excessive temperature difference	
	Low Charging Temperature	<ol style="list-style-type: none"> 1. The environment temperature is too low. Check the environment to ensure that the installation temperature of the battery system meets the operating temperature range of the battery. 2. Power off the battery and wait for the temperature to recover before powering it on again.
	Low Discharging Temperature	

	Overcurrent Charging	Restart the battery. Contact the after-sale service if the problem persists.
	Overcurrent Discharging	Restart the battery. Contact the after-sale service if the problem persists.
	Low Insulation Resistance	Contact the after-sale service.
	Voltage Difference Exception	Restart the battery and leave it for 12 hours. Contact the after-sale service if the problem persists
	Inconsistent Cell	Some battery modules in the battery system have incorrect models. Please contact the dealer to replace the battery module and reinstall it.
	Wire Harness Exception	Restart the battery. Contact the after-sale service if the problem persists.
	Relay Connection Failure	Restart the battery. Contact the after-sale service if the problem persists.
	Relay Adhesion	Restart the battery. Contact the after-sale service if the problem persists.
	Cluster Fault	Check the battery model. Contact the after-sale service if the battery model is incorrect.
	Interlock Failure	<ol style="list-style-type: none"> 1. Check whether the termination resistor is installed properly and restart the battery. 2. Contact the after-sale service if the problem persists.
	BMU Communication Fault	Restart the battery. Contact the after-sale service if the problem persists.
	MCU Internal Communication Fault	Restart the battery. Contact the after-sale service if the problem persists.
	Air Switch Adhesion	Contact the after-sale service.
	Precharge Failure	Restart the battery. Contact the after-sale service if the problem persists.
	Relay Overtemperature	Power off and wait for 2 hours. Contact the after-sale service if the problem persists.
	Current Diverter Overtemperature	Power off and wait for 2 hours. Contact the after-sale service if the problem persists.
	Reverse Connection Fault	The positive and negative poles of the battery system power cable are reversed. Please reconnect the power cable.
	Microelectronic Fault	Contact the after-sale service.

9 Technical Parameters

Technical Parameters	LX F9.6- H-20	LX F12.8- H-20	LX F16.0- H-20	LX F19.2- H-20
Usable Energy (kWh)* ¹	9.6	12.8	16.0	19.2
Battery Module	LX F3.2-20: 64V 3.2kWh			
Number of Modules	3	4	5	6
Cell Type	LFP (LiFePO ₄)			
Nominal Voltage (V)	192	256	320	384
Operating Voltage Range (V)	172.2~216.6	229.6~288.8	287~361	344.4~433.2
Nominal Dis-/Charge Current (A)* ²	35			
Nominal Dis-/Charge Power (kW)* ²	6.72	8.96	11.2	13.44
Operating Temperature Range (°C)	Charge: 0~+50; Discharge: -20~+50			
Relative Humidity	0~95%			
Max. Operating Altitude (m)	3000			
Communication	CAN			
Weight (kg)	120	154	188	222
Dimension (W×H×D mm)	600×715×380	600×871×380	600×1027×380	600×1183×380
Ingress Protection Rating	IP55			
Mounting Method	Grounded			
Standard and Certification	Safety	IEC62619, IEC62040-1, IEC63056, VDE2510, CE , CEC		
	EMC	CE, RCM		
	Transportation	UN38.3		
<p>*1: Test conditions, 100% DOD, 0.2°C charge & discharge at +25±2 °C for battery system at beginning life. System Usable Energy may vary with different inverter.</p> <p>*2: Nominal Dis-/Charge Current and power derating will occur related to Temperature and SOC.</p> <ul style="list-style-type: none"> • When a single battery system is applied, the Nominal Dis-/Charge Current is 35A. • When two battery systems are applied, the Nominal Dis-/Charge Current is 70A. • When more than three battery systems are applied, the Nominal Dis-/Charge Current is 100A. 				

Technical Parameters		LX F22.4- H-20	LX F25.6- H-20	LX F28.8- H-20
Usable Energy (kWh)* ¹		22.4	25.6	28.8
Battery Module		LX F3.2-20: 64V 3.2kWh		
Number of Modules		7	8	9
Cell Type		LFP (LiFePO ₄)		
Nominal Voltage (V)		448	512	576
Operating Voltage Range (V)		401.8~505.4	459.2~577.6	516.6~649.8
Nominal Dis-/Charge Current (A)* ²		35		
Nominal Dis-/Charge Power (kW)* ²		15.68	17.92	20.16
Operating Temperature Range (°C)		Charge: 0~+50; Discharge: -20~+50		
Relative Humidity		0~95%		
Max. Operating Altitude (m)		3000		
Communication		CAN		
Weight (kg)		256	290	324
Dimension (W×H×D mm)		600×1339×380	600×1495×380	600×1651×380
Ingress Protection Rating		IP55		
Mounting Method		Grounded		
Standard and Certification	Safety	IEC62619, IEC62040-1, IEC63056, VDE2510, CE, CEC		
	EMC	CE, RCM		
	Transportation	UN38.3		
<p>*1: Test conditions, 100% DOD, 0.2C charge & discharge at +25±2 °C for battery system at beginning life. System Usable Energy may vary with different inverter.</p> <p>*2: Nominal Dis-/Charge Current and power derating will occur related to Temperature and SOC.</p> <ul style="list-style-type: none"> • When a single battery system is applied, the Nominal Dis-/Charge Current is 35A. • When two battery systems are applied, the Nominal Dis-/Charge Current is 70A. • When more than three battery systems are applied, the Nominal Dis-/Charge Current is 100A. 				



Official
Website

GoodWe Technologies Co.,Ltd.

 No. 90 Zijin Rd., New District, Suzhou, 215011, China

 T: 400-998-1212

 www.goodwe.com

 service@goodwe.com



Contact Information